

RECOMMENDED DEVELOPMENT PLAN

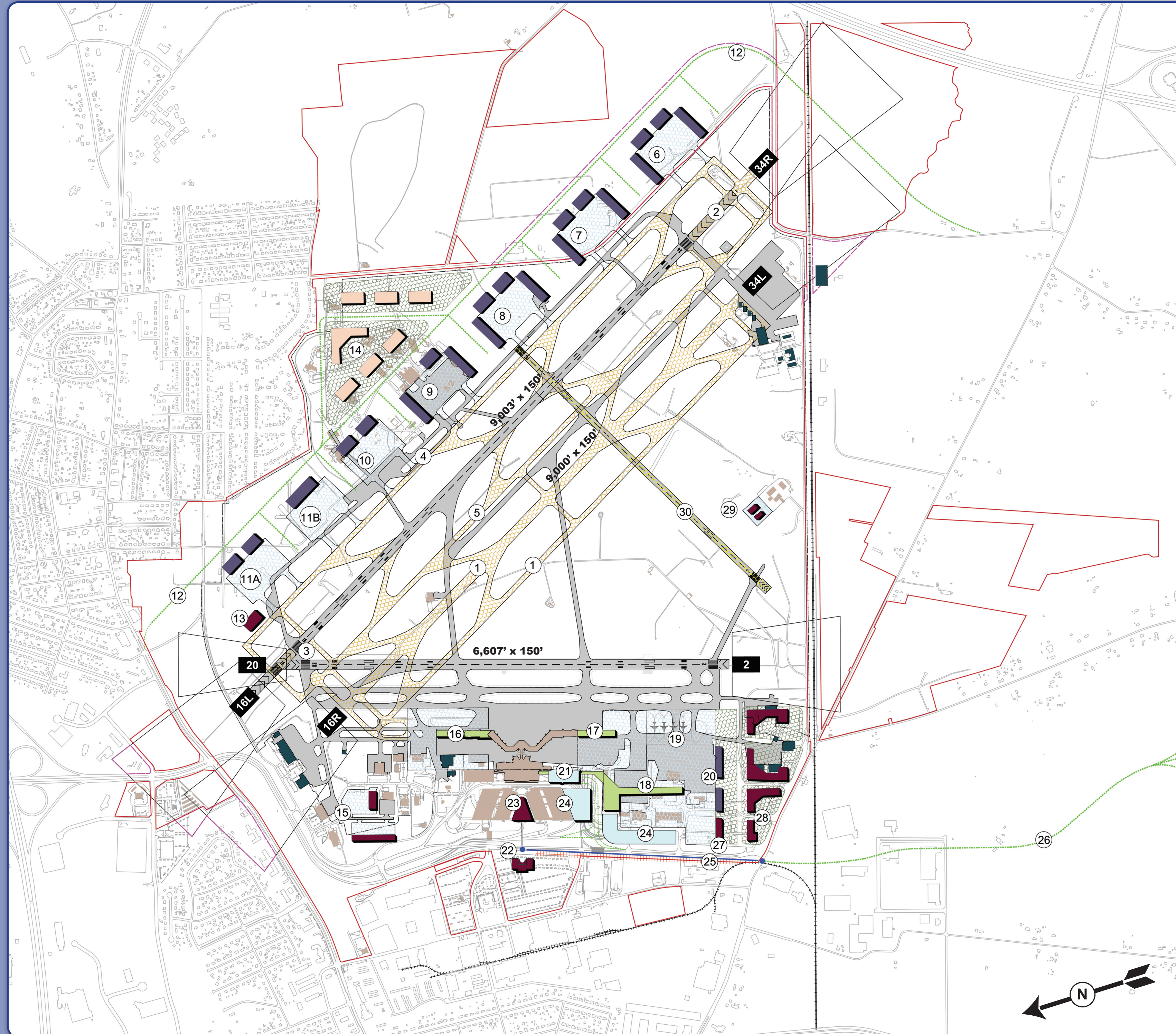

Legend

| | EXISTING | FUTURE |
|-----------------------------|----------|--------|
| AIRFIELD PAVEMENTS | | |
| APRON PAVEMENTS | | |
| LANDSIDE PAVEMENTS | | |
| AIRPORT PROPERTY LINE (FEE) | | |
| RUNWAY PROTECTION ZONE | | |
| RAIL LINE | | |
| ROADWAY IMPROVEMENTS | | |
| RUNWAY TO BE DOWNGRADED | | |
| EXISTING STRUCTURES | | |

FUTURE PROJECTS

- 1 PARALLEL RUNWAY 16R-34L AND TAXIWAYS
- 2 RUNWAY 34R EXTENSION
- 3 RUNWAY 16L EXTENSION
- 4 TAXIWAY M REALIGNMENT
- 5 TAXIWAY L REALIGNMENT
- 6 FUTURE HEAVY AIRCRAFT MAINTENANCE AND MODIFICATIONS
- 7 RELOCATED GA AND COMMERCIAL AVIATION MAINTENANCE
- 8 RELOCATED AIR CARGO FACILITIES
- 9 FEDERAL GOVERNMENT AVIATION COMPLEX
- 10 CORPORATE AVIATION HANGAR FACILITIES
- 11 A) PHASE I RELOCATED FBO FACILITIES
- 11 B) PHASE II RELOCATED FBO FACILITIES
- 12 EAST AIRSIDE ACCESS ROAD AND BEULAH RD. REALIGNMENT
- 13 RELOCATED ARFF STATION
- 14 AIR CARGO SUPPORT FACILITIES
- 15 AIR CARRIER SUPPORT FACILITIES
- 16 A) PHASE I APRON AND CONCOURSE A EXPANSION
- 16 B) PHASE II CONCOURSE A EXPANSION
- 17 A) PHASE I APRON EXPANSION
- 17 B) PHASE II CONCOURSE B EXPANSION
- 18 A) PHASE I SURFACE PARKING
- 18 B) PHASE II NEW TERMINAL AND CONCOURSE C
- 19 DEICING AND DIVERSION APRON
- 20 RELOCATED BELLY CARGO AND GSE BUILDING
- 21 REMOTE PARKING GARAGE
- 22 CONSOLIDATED RENTAL CAR FACILITY (CONRAC)
- 23 CONFERENCE CENTER
- 24 SURFACE PARKING AND PARKING GARAGE
- 25 REGIONAL RAIL CONNECTION
- 26 POCAHONTAS 895 AIRPORT CONNECTOR
- 27 RELOCATED FUEL FARM
- 28 AIRPORT BUSINESS PARK
- 29 AIRPORT MAINTENANCE FACILITY EXPANSION
- 30 CONVERSION OF RUNWAY 7-25 INTO TAXIWAY

FUTURE FACILITIES

| | |
|---------------------------|--|
| SUPPORT FACILITIES | |
| CARGO FACILITIES | |
| TERMINAL FACILITIES | |
| PARKING FACILITIES | |
| BUILDING TO BE DEMOLISHED | |
| NON-AVIATION FACILITIES | |